

PRO PLUG SYSTEM®

Wood

Hidden Fastener for Wood Decking and Flooring



APPLICATION

Hidden fastening system that provides a secure face-fastened connection with precision cut, face grain plugs made from a variety of hardwood decking and flooring. Installation is a four step process utilizing a predrilling tool, glue (sold separately), screw and plug.

FEATURES

- Provides the strength of top-down fastening with the high end finish of face grain wood plugs
- Drill, screw, glue and plug all types of hardwoods in a fraction of the time compared to traditional plug methods
- Patented Wood Tool creates a screw hole, countersink and counterbore to match other system components
- Free spinning stop collar on Wood Tool prevents damage to the board surface
- Patented glue nozzle applies glue to the sidewall of the counterbored hole
- Kit packaging includes screws, plugs and glue nozzle (Wood Tool sold separately)

INSTALLATION

Follow all decking and flooring manufacturer instructions, including specifications for screw spacing, edge/end distances, and gapping.

- Predrill with the countersinking Wood Tool using a corded drill on high speed until the collar stops spinning. Remove debris from hole.
- Drive screw so that it is fully seated in the countersink. (Do not overtighten.)
- Fit glue nozzle on glue bottle. Apply glue to hole by pushing down and gently squeezing the bottle while rotating it one quarter turn, then remove. Glue should coat the side walls of the hole.
- Insert plug into hole, align grain of plug to match grain of board, and tap with a smooth-faced hammer until the plug is flush with board.

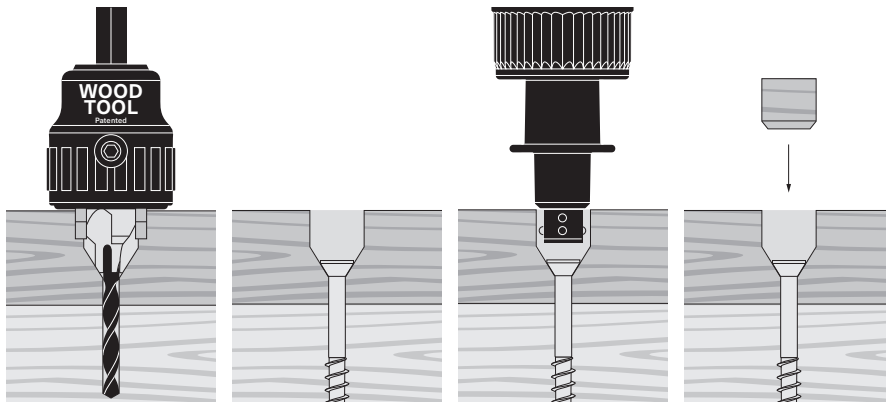

FINISH
DECKING KITS
Grade 305 Stainless Grade 316 Stainless
FLOORING KITS
Grade 305 Stainless
CORROSION
DECKING & FLOORING KITS
Exterior use
Approved for use in ACQ and pressure treated lumber.
For salt water or other areas where corrosion is a concern, use Grade 316 Stainless.
DRIVE SYSTEM
Star drive
TOOL COMPATIBILITY
Wood Tool Wood Tool Replacement Bits

PLUGS AVAILABLE IN THE FOLLOWING HARDWOOD DECKING

ALASKAN YELLOW CEDAR	BAMBOO	CAMBARA	CUMARU	DASSOXTR FUSED BAMBOO*
GARAPA	IPE	IRON WOODS*	JATOBA	KEBONY*
MAHOGANY	MASSARANDUBA	MERANTI	MERBAU	PEDRA
PROTEAK	RED BALAU	THERMORY*	TIGERWOOD	YELLOW BALAU

PLUGS AVAILABLE IN THE FOLLOWING HARDWOOD FLOORING

AMERICAN CHERRY	AMERICAN WALNUT	EASTERN WHITE PINE	MAHOGANY	POPLAR
RED OAK	WHITE OAK			

New board brands are always being added to our product offering. Please refer to our website or contact Starborn® customer service if you do not see the board brand you are looking to use on your project.

SYSTEM COMPONENTS

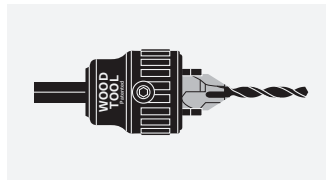

Countersinking Wood Tool

For predrilling and countersink (Sold separately)

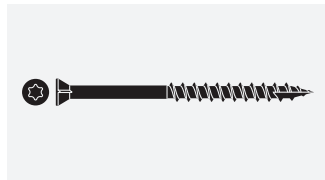

Screws

Grade 305 or Grade 316 stainless for decking, Grade 305 stainless for flooring

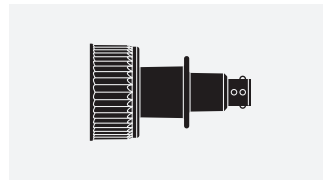

Glue Nozzle

Applies glue to sidewalls of screw hole

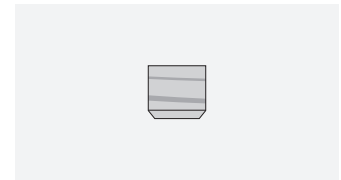

Plugs

Made from actual hardwood species

PRO PLUG® SYSTEM WOOD PACKAGING

DECK KIT PACKAGING					
LENGTH	FINISH	COVERAGE	SCREWS	PLUGS	TOOL
1-5/8"	305 Stainless	25 sq ft	100	100	—
		100 sq ft	350	350	—
		300 sq ft	1050	1050	—
2-1/2"		25 sq ft	100	100	—
		100 sq ft	350	350	—
		300 sq ft	1050	1050	—
1-5/8"	316 Stainless	25 sq ft	100	100	—
		100 sq ft	350	350	—
		300 sq ft	1050	1050	—
2-1/2"		25 sq ft	100	100	—
		100 sq ft	350	350	—
		300 sq ft	1050	1050	—

FLOOR KIT PACKAGING					
LENGTH	FINISH	COVERAGE	SCREWS	PLUGS	TOOL
1-5/8"	305 Stainless	25 sq ft	100	100	—
		100 sq ft	350	350	—
		300 sq ft	1050	1050	—

STARBORN DECKMATCHER TABLE

STARBORN COLOR	ARMADILLO	CLUBHOUSE	DECORATORS	DURALIFE	ENDECK	ENVISION	EVA-LAST	FIBERON
TAN-GRAY #31	CAMPFIRE • FIREWOOD • MESA • PAINTED DESERT	COBBLESTONE	COASTLAND • COSTA • HICKORY	MAHOGANY • TROPICAL WALNUT	CEDAR • SABLE	WEATHERED WOOD SPICED TEAK • TANTRIDGE OAK • VINTAGE OAK	ALASKAN DRIFTWOOD • CAPE TOWN GREY • CONCRETE GRAY	CABIN • IPE • JATORA • MORINGA • MUNA • TULI • TUDOR BROWN • DUNE • SUMAC • TUDOR BROWN
BROWN #34	CONVOY	HICKORY	ASHWOOD • COMPASS GRAY • FIELDSTONE • GRAY • KETTLE • SALTWATER • SILVERWOOD • SUMMIT	IRONSTONE	SLATE	ALPINE FOG • CAPE COD GREY • NANTUCKET SHORE	CARRIBBEAN CORAL • GRAY SLATE • SAPPHIRE SILVER • CARBONIZED OSAGE • CHARRED CEDAR	CASTLE GRAY • COTTAGE • MINERAL • MORA • NANTUCKET GRAY • SEASIDE MIST
GRAY #37								
BLACK #38								
WHITE #39	LINEN • WHITE SAND							
ASHWOOD #43		SANDSTONE	MACADAMIA					
IVORY #45								
KHAKI #48								
DARK GRAY #53	CANYON GRAY • SMOKE • STEEL WOOL • THUNDER	DRIFTWOOD	DUSK • LAKEVIEW • RIDGELINE • RIDGEMAN • SIERRA • SMOKEHOUSE	ARCADIA GRAY • GARAPA GREY • SLATE	DAWN	GREY WOOD • HARBOR GREY	ALASKAN DRIFTWOOD • CAPE TOWN GREY • CONCRETE GRAY	BEACH HOUSE • FLAGSTONE • GRAPHITE • MOONLIGHT COVE • PALO
WARM GRAY #54		BROOKSTONE	TUNDRA	COASTAL GREY	DAWN	BARNWOOD PLANK • GUNSTOCK	ARCTIC BIRCH	CABANA • CHAI • SANDSTONE • SHADED CAY
DARK SLATE #55	CHARCOAL	IRONWOOD	DRIFTWOOD • SLATE (PICTURE FRAME)				SIBERIAN BARK	EARL GREY • GRAY BIRCH • WEATHERED CLIFF • WENGE
COOL GRAY #56	DOVE TAIL						SWEDISH OAK	BAMBOO • PRAIRIE WHEAT CLAY • TUSCAN VILLA • WARM SIENNA
SAHARA #62								
BUCKSKIN #63								
SAND #64	SAW GRASS	CLAY	CEDAR • DUNEWOOD • SANDALWOOD • TIMBERLINE	ASPEN TEAK • PEBBLE	DUSK • OLIVEWOOD	HAMPTON DUNE • SANDSTONE • SEASIDE PIER	HIMALAYAN CEDAR	
ROSY BROWN #65							SAHARA SAND • WEATHERED ASH	BROWNSTONE
CHOCOLATE #71	BOURBON • FOOTHILLS • SALCOON • TWILIGHT • WALNUT	WALNUT	BARREL AGED OAK • KHAYA • IRONWOOD • PATHWAY • RIVERHOUSE • SHIPYARD BROWN	CABO BROWN • MOCHA	CHESTNUT	BLACK WALNUT • RUSTIC WALNUT • WEATHERED WICKER • WOODLAND BARK	SAHARA SAND • WEATHERED ASH	BROWNSTONE
JAVA #73	BRONCO • TORTOISE • TUMBLEWEED • VINTAGE SLATE	MAHOGANY	CANYON • CHICORY • KINGWOOD • RIVERSIDE • ROSEWOOD • WALNUT • WOODLAND	SEQUOIA		CANYON RIDGE • CARRIBOU BROWN • SHADED AUBURN	SPANISH SAFFRON • TIGER COVE	BUNGALOW • CHESTNUT • MOUNTAIN ASH • ROSEWOOD • SANDY PIER
CEDAR #81			SEDONA	BRAZILIAN CHERRY • GOLDEN TEAK		CEDAR	BARREL OAK • CHESTNUT CEDAR • NATURAL CEDAR • WESTERN RED CEDAR • ISLAND MAHOGANY • NATURAL IPE	TUPELO
MAHOGANY #82	RUSTIC RED • SUNSET					REDWOOD		
BURGUNDY #87								
STARBORN COLOR	MOISTURESHIELD	SYLVANIX	TIMBERTECH	TEX	TRUNORTH	VEKADOCK	WEARBECK	WOLF
TAN-GRAY #31	EARTH TONE	MESA BROWN • SANDPOINT • SPANISH CEDAR • TEAK	AUTUMN CHESTNUT • WEATHERED TEAK ANTIGUA GOLD • BROWN OAK • DARK ROAST • DARK TEAK • ENGLISH WALNUT • MAHOGANY • MORADO	HAWAII GOLD • JASPER • CORACOKE • SADDLE • TREE HOUSE	SAND	CAVENNE	WEATHERWOOD	WEATHERED IPE AMBERWOOD • CEDAR RIDGE • ROSEWOOD
BROWN #34	BRIDE • CAJONE • TIGERWOOD • WALNUT		ISLAND OAK • SANDSTORM GRAY • WEATHERED OAK	PEBBLE GREY • ROCKY HARBOR • WHIBBEY	HAZELWOOD • STONE GREY	STORM	SADDLE	
GRAY #37	ALPINE GRAY • AURORA MIST • CAPE COD GRAY • CATHEDRAL STONE • CTADEL • LAKE FOG	SUMMIT GREY	ASHWOOD • CASTLE GATE • COASTLINE • DRIFTWOOD • MARITIME GRAY • SEASALT GRAY • SILVER MAPLE • STONE FISH • STORM GRAY	WOOD GRAIN WHITE		WHITE	GRAY	DRIFTWOOD GREY • POTOMAC GREY
WHITE #39			BEACHWOOD GRAY • RECLAIMED CHESTNUT • WHITE HAZELWOOD			WHITE	WHITE	
ASHWOOD #43								
IVORY #45								
OLIVE GRAY #51								
DARK GRAY #53	GRAYSTONE • HARBOR GRAY • SMOKEY GRAY • SOUTHERN BARNWOOD	ASPEN GRAY • GRAPHITE • LAKE GREY • PONDERAY	ISLAND OAK • SANDSTORM GRAY • WEATHERED OAK	CLAM SHELL • ISLAND MIST	AMAZON GREY • ASH GREY	KHAKI	BARREFOOT GRAY	PUMICE
WARM GRAY #54	CATALINE • SANDSTONE		BOARDWALK • GREY • SLATE GRAY AMAZON MIST	BISCAYNE • GRAVEL PATH WINCHESTER GREY FOGGY WHARF • RAINIER				HARBOR GREY ONYX
DARK SLATE #55								
COOL SLATE #56								
SAHARA #62								
BUCKSKIN #63	SHORESIDE	SAND DUNE HARVEST BROWN • TROPICAL GOLD	NATURAL WHITE OAK ANTIQUE LEATHER • COCONUT HUSK • TIGERWOOD	CARMEL • ROPE SWING	TIGERWOOD		BARREFOOT SAND	ALMOND • GOLDEN CYPRESS
SAND #64	DESERT SAND • MOCHACCINO		BROWNSTONE • FRENCH WHITE OAK • SANDY BIRCH • TIDAL SAND				SAND	SAND CASTLE • SILVER TEAK • WILLOW CASHMERE
ROSY BROWN #65								
CHOCOLATE #71	RIVERBANK • SPANISH LEATHER	MERLOT • VANTAGE	CEDAR • PECAN • SILVER OAK	BEACH DUNE • TOASTED SAND COASTAL BLUFF • VINTAGE LANTERN • WOODLAND BROWN	BRULE	HAZELNUT • WALNUT		BLACK WALNUT • MOCHA
JAVA #73	BRAZILIAN CHESTNUT • COL D'EBREU • GRAPHITE • KAYAK • IPE • LANTIER • NORTHERN ROSEWOOD • RUSTIC TIMBER	CHERRYWOOD	ACACIA • AMERICAN WALNUT • BRAZILIAN WALNUT • DARK COCOA • DARK HICKORY • ESPRESSO • KONA	FIRE PIT • LAVA ROCK • SPICED RUM • SUNSET COVE	CHERRYWOOD • TROPICAL WALNUT	ESPRESSO	CEDAR	ACACIA • CINNAMON
CEDAR #81	RUSTIC CEDAR		ANTIQUE PALM • CARIBBEAN REDWOOD • DARK OAK • RUSTIC ELM • SABLE CYPRESS	TIKI TORCH	RED BORDEAUX			TEAKWOOD REDWOOD
MAHOGANY #82								
BURGUNDY #87	SEASONED MAHOGANY			MADERA				

Visit starbornindustries.com/deck-matcher for an interactive version of this chart, which also includes wood decking. The online version is updated frequently with new boards and colors.

Starborn Industries, Inc. Edison, NJ 08837 USA
Rev. Date: 2025-03